

### HARMONIA SERIES

### Robe hook

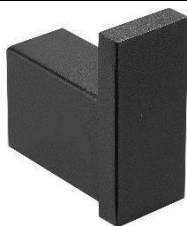

**AI1418B**  
Black finish



**AI1418C**  
Bright finish



**AI1418CS**  
Satin finish

#### General Description

- Single bathroom robe hook for fixing to the bathroom wall, straight-lined and made of AISI 304 stainless steel, from Mediclinics' Harmonia series.
- The high-quality, anti-corrosive and highly resistant stainless steel makes these wall hangers very high quality and durable.
- As these small but functional bathroom robe hooks come in single units, you can combine as many as you want.
- These bathroom robe hooks are ideal for your own home, as well as for public-use bathrooms such as hotels, restaurants, airports and changing rooms.
- With an up-to-date and minimalist design, these robe hooks are ideal bathroom accessories to add to elegant and modern spaces.
- This robe hook is one of the most essential bathroom accessories for keeping your bathroom tidy and making the most of the space.
- It has a hidden wall mounting system.
- Comes with stainless steel hardware kit.

#### Components and materials

- **AI1418B:** robe hook made of AISI 304 stainless steel black finish.
- **AI1418C:** robe hook made of AISI 304 stainless steel bright finish.
- **AI1418CS:** robe hook made of AISI 304 stainless steel satin finish.
- **HOOK:** manufactured with rectangular AISI 304 stainless steel tube.
- **WALL BRACKETS:** one unit, made with AISI 304 stainless steel rectangular tube of 38x25mm and 1mm de thick. Attached to the bar by means of a threaded stud and nut.
- **WALL ANCHORS:** one unit, made of aluminum. Attached to the wall bracket by means of two screws. It has two holes for wall mounting. They always remain hidden from the user's view.

#### Technical Specifications

<b>Dimensions</b>	60 x 67 x 30 mm
<b>Wall bracket thickness</b>	1.0 mm
<b>Net weight</b>	160 g

#### Dimensions

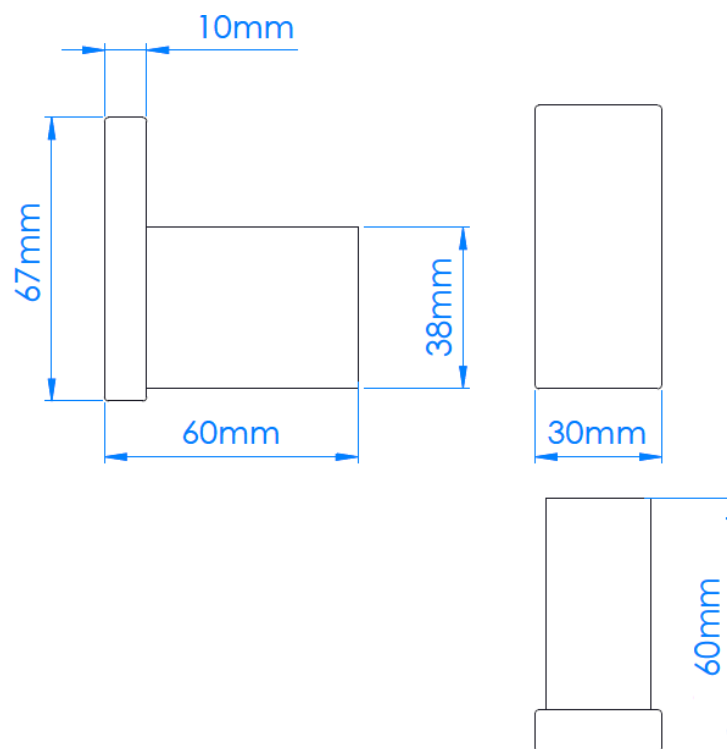

Dimensions: ± 4%

#### TEXT FOR PRESCRIPTION

Single hook in right-angle shape, shall weigh 0,16 kg. It shall be made of AISI 304 stainless steel in black, bright, or satin finish. The hook shall have a thickness of 10 mm. The hook shall have one wall support, 1,0 mm thick. It shall have one wall fixing attached to the support with a screw.