

AURA SERIES

Double robe hook



AI2318B
Black finish



AI2318C
Bright finish



AI2318CS
Satin finish

General Description

- Double-ended bathroom robe hook, made of AISI 304 stainless steel, from Mediclinics' Aura series.
- With a versatile and up-to-date air, these bathroom robe hooks combine aesthetics and functionality, making them ideal to decorate elegant and modern bathroom spaces.
- These wall hangers allow you to optimize and keep the bathroom space tidy, making them one of the most essential bathroom accessories.
- Extremely durable thanks to their high-quality, anti-corrosive and highly resistant stainless steel.
- Ideal for bathrooms with high usage such as those in hotels, airports, restaurants, sports complexes, etc.
- Product suitable for public use.
- They have a hidden wall mounting system.
- Includes stainless steel hardware kit for installing on brick walls.

Components and materials

- **AI2318B:** double robe hook made of AISI 304 stainless steel black finish.
- **AI2318C:** double robe hook made of AISI 304 stainless steel bright finish.
- **AI2318CS:** double robe hook made of AISI 304 stainless steel satin finish.
- **DOUBLE HOOK:** made of 5 mm thick AISI 304 stainless steel plate.
- **WALL BRACKETS:** two units, made with AISI 304 stainless steel cylindrical tube of Ø 28mm and 1.2mm thick. Attached to the bar by means of a threaded stud and nut.
- **WALL ANCHORS:** two units made of AISI 304 stainless steel tube of Ø 22mm and 1.0mm thick. Attached to the wall bracket by means of a screw. It has two oval holes (one vertical and one horizontal) to facilitate wall mounting. They always remain hidden from the user's view.

Technical Specifications

Dimensions	55 x 55 x 90 mm
Hook thickness	5 mm
Wall bracket diameter	28 mm
Wall bracket thickness	1,2 mm
Net weight	180 g

Dimensions

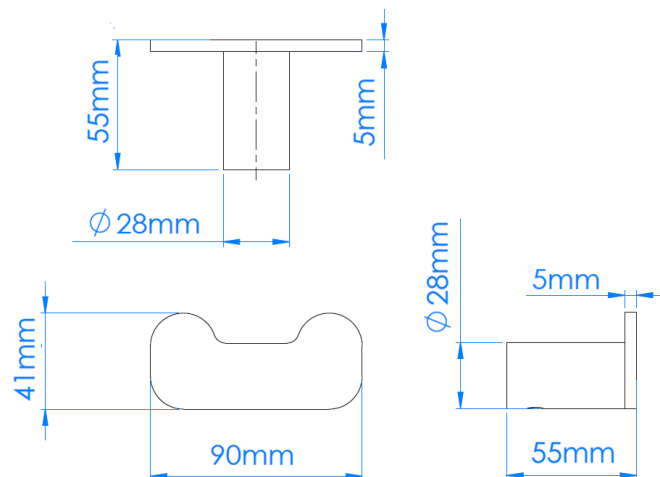

Dimensions: ± 4%

TEXT FOR PRESCRIPTION

Double-ended hook, shall weigh 0,18 kg. It shall be made of AISI 304 stainless steel in black, bright, or satin finish. The double hook shall have a thickness of 5 mm. The hook shall have one wall support 1,2 mm thick. It shall have one wall fixing attached to the support with a screw.

