

TOILET SEAT WITH COVER

MDF



TP0140
Mahogany finish



TP0145
Black finish

General description

- Toilet seat with lid, suitable for Mediclinics toilet models SN0120CS, SN0125CS and SN0128CS.
- Made of Medium Density Fibreboard (MDF)
- The hinges that fix the seat and the lid are made of stainless steel.
- Easy to install and clean.
- Suitable for public restrooms

Components and materials

- **TP0140:** Toilet seat with lid made of MDF, mahogany finish.
- **TP0145:** Toilet seat with lid made of MDF, black finish.
- **SEAT AND LID:** Manufactured with MDF.
- **HINGES:** 2 units made of stainless steel.

Technical Specifications

Dimensions	364x444x46,5-53,5 mm
------------	----------------------

Dimensions

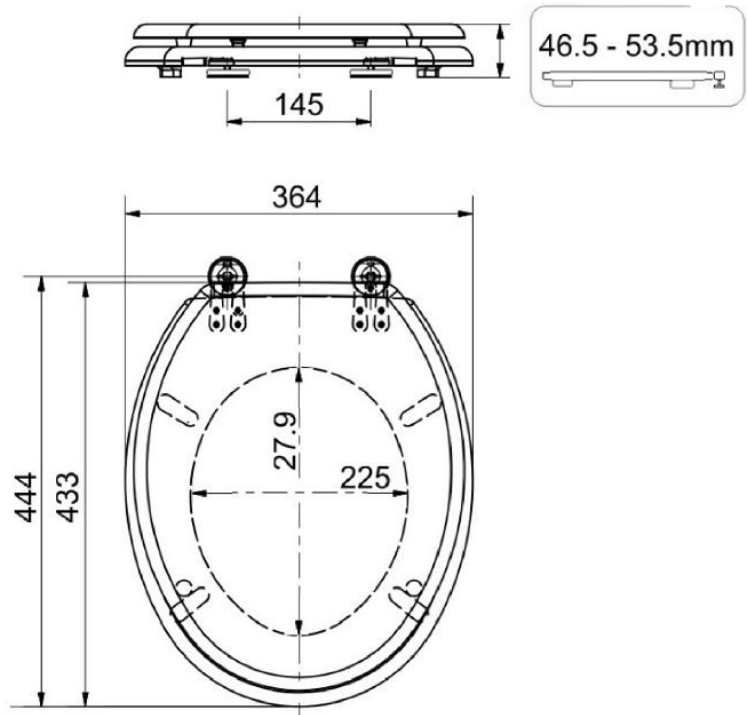

ASSEMBLY

On Mediclinics toilets SN0125CS and SN0128CS with the supplied fixings and in the threaded holes of the toilet.